

INDUSTRIAL FOR SALE

SPRINGS GLOBAL US, INC. WAREHOUSE

201 5th Avenue North
Piedmont, Alabama 36272



TOTAL SIZE	190,750 sf
OFFICE SPACE	9,150 sf
MEZZANINE	20,000 sf
SITE SIZE	7 acres
SALES PRICE	\$2,500,000

BUILDING FEATURES

- Former production & distribution facility for Spring industries, now Springs Global, the world's largest manufacturer of textile home furnishings
- Clean, efficient facility with ample parking and loading areas. The building was constructed in phases; 1952, 1962, 1972 & 1988
- Located approximately 30 miles north of Anniston, AL (I-20), and approximately 30 miles Southeast of Gadsden, AL (I-59)

FOR MORE INFORMATION, PLEASE CONTACT:

Mark Byers, SIOR
Executive Vice President
(205) 314-5522
mbyers@egsinc.com

Deborah McGill, CEcD
Brokerage & Consulting
(xxx205) 314-5534
dmcgill@egsinc.com

EGS COMMERCIAL REAL ESTATE, INC.
505 20th Street North, Suite 700
Birmingham, AL 35203
(205) 939-4440
www.egsinc.com

The depiction in the included photograph of any person, entity, sign, logo or property, other than EGS Commercial Real Estate, Inc.'s (EGS) client and the property offered by EGS, is incidental only, and is not intended to connote any affiliation, connection, association, sponsorship or approval by or between that which is incidentally depicted and EGS or its client. No warranty or representation, express or implied, is made as to the accuracy of the information contained herein, and same is submitted subject to errors, omissions, change of price, rental or other conditions, withdrawal without notice, and to any specific listing conditions, imposed by our principals.





SPRINGS GLOBAL US, INC. WAREHOUSE

201 5th Avenue North
Piedmont, Alabama 36272

INDUSTRIAL FOR SALE

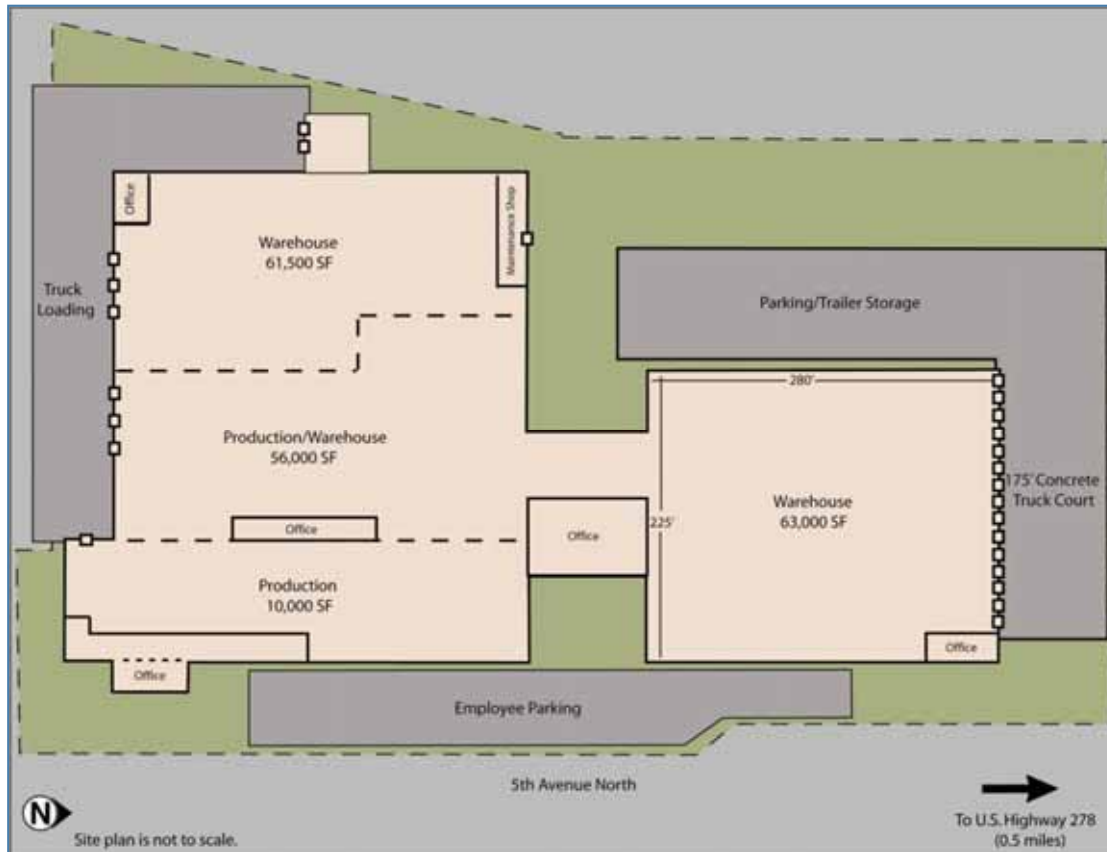

BUILDING FEATURES

- 24 dock-high doors & 2 drive-in doors
- Loading doors have dock-locks, lights, seals and levelers
- Wet sprinkler system throughout
- Separate 3-phase power to all four sections of the building
- Two, 2-ton overhead cranes
- 66,000 sf of climate controlled space
- Conveyor system from production area to distribution area
- Site has perimeter lighting and is fenced
- Ceiling height: 10,000 sf – 11'
56,000 sf – 17'
61,500 sf – 17'
63,000 sf – 23' to 29'

FOR MORE INFORMATION, PLEASE CONTACT:

Mark Byers, SIOR
Executive Vice President
(205) 314-5522
mbyers@egsinc.com

Deborah McGill, CECD
Brokerage & Consulting
(xxx205) 314-5534
dmcgill@egsinc.com

EGS COMMERCIAL REAL ESTATE, INC.
505 20th Street North, Suite 700
Birmingham, AL 35203
(205) 939-4440
www.egsinc.com

The depiction in the included photograph of any person, entity, sign, logo or property, other than EGS Commercial Real Estate, Inc.'s (EGS) client and the property offered by EGS, is incidental only, and is not intended to connote any affiliation, connection, association, sponsorship or approval by or between that which is incidentally depicted and EGS or its client. No warranty or representation, express or implied, is made as to the accuracy of the information contained herein, and same is submitted subject to errors, omissions, change of price, rental or other conditions, withdrawal without notice, and to any specific listing conditions, imposed by our principals.

