

## INDUSTRIAL FOR LEASE

# CAHABA VALLEY BUSINESS PARK

I-65 at Cahaba Valley Road (Alabama 119)  
Pelham, Alabama 35124

## BIRMINGHAM'S PREMIER OFFICE/WAREHOUSE DEVELOPMENT



### BUILDING FEATURES

- Convenient location to Hwy 119, Hwy 31 & I-65
- Office/warehouse spaces ranging from 2,250 – 20,000 sf
- Dock-high & Drive-in loading
- 16' – 24' clear height
- Conditioned warehouse available



### FOR MORE INFORMATION, PLEASE CONTACT:

#### Brad Moffatt

Vice President - Industrial  
(205) 314-5509  
bmoffatt@egsinc.com

#### Stuart Brock

Leasing & Brokerage  
(205) 314-5561  
sbrock@egsinc.com,

### EGS COMMERCIAL REAL ESTATE, INC.

505 20th Street North, Suite 700  
Birmingham, AL 35203  
(205) 939-4440  
[www.egsinc.com](http://www.egsinc.com)

The depiction in the included photograph of any person, entity, sign, logo or property, other than EGS Commercial Real Estate, Inc.'s (EGS) client and the property offered by EGS, is incidental only, and is not intended to connote any affiliation, connection, association, sponsorship or approval by or between that which is incidentally depicted and EGS or its client. No warranty or representation, express or implied, is made as to the accuracy of the information contained herein, and same is submitted subject to errors, omissions, change of price, rental or other conditions, withdrawal without notice, and to any specific listing conditions, imposed by our principals.





# CAHABA VALLEY BUSINESS PARK

I-65 at Cahaba Valley Road (Alabama 119)  
Pelham, Alabama 35124

**INDUSTRIAL FOR LEASE**

**BIRMINGHAM'S PREMIER OFFICE/WAREHOUSE DEVELOPMENT**

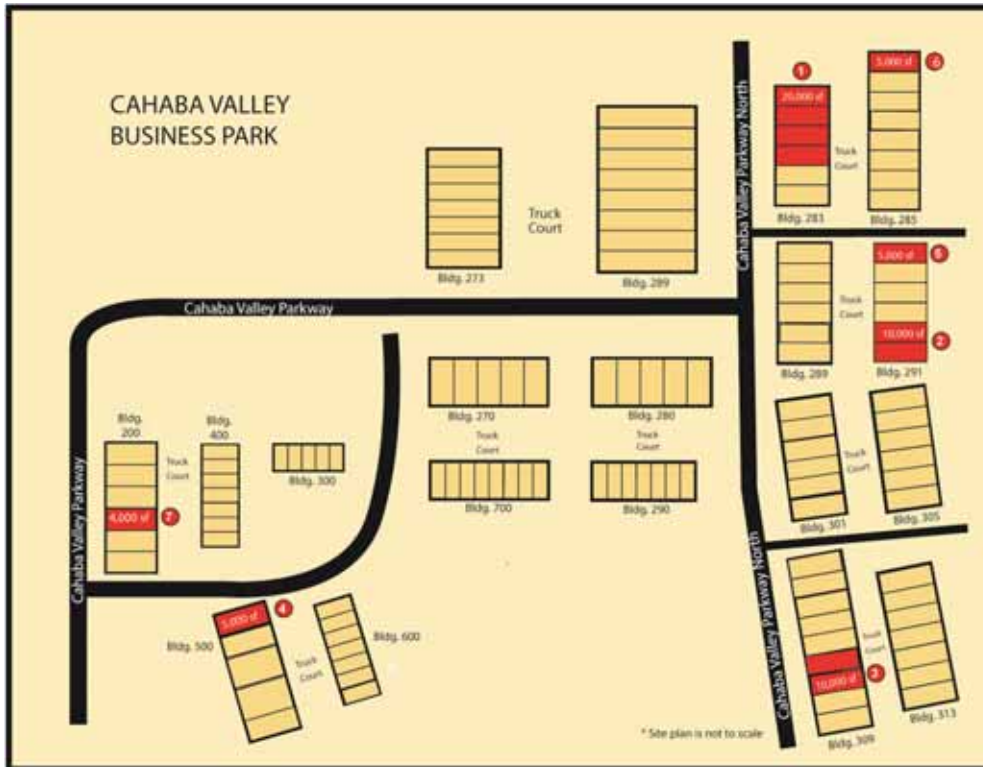

#	BUILDING	TOTAL SF	FINISHED SF	LOADING	RATE PSF
1	283	20,000	3,850	(3) Dock-high (1) Drive-in	\$7.00
2	291	10,000	1,000	(4) Dock-high	\$6.00
3	309	10,000	1,450	(3) Dock-high (1) Drive-in	\$6.50
4	500	5,000	4,600	(1) Dock-high	\$8.00
5	291	5,000	3,000	(2) Dock-high	\$7.25
6	285	5,000	0	(1) Dock-high (1) Drive-in	\$3.75
7	200	4,000	0	(1) Dock-high	\$3.75

Above rates are quoted on an industrial gross basis. Square footages provided are approximate.

**FOR MORE INFORMATION, PLEASE CONTACT:**

**Brad Moffatt**  
Vice President - Industrial  
(205) 314-5509  
bmoffatt@egsinc.com

**Stuart Brock**  
Leasing & Brokerage  
(205) 314-5561  
sbrock@egsinc.com,

**EGS COMMERCIAL REAL ESTATE, INC.**  
505 20th Street North, Suite 700  
Birmingham, AL 35203  
(205) 939-4440  
[www.egsinc.com](http://www.egsinc.com)

The depiction in the included photograph of any person, entity, sign, logo or property, other than EGS Commercial Real Estate, Inc.'s (EGS) client and the property offered by EGS, is incidental only, and is not intended to connote any affiliation, connection, association, sponsorship or approval by or between that which is incidentally depicted and EGS or its client. No warranty or representation, express or implied, is made as to the accuracy of the information contained herein, and same is submitted subject to errors, omissions, change of price, rental or other conditions, withdrawal without notice, and to any specific listing conditions, imposed by our principals.

